



4700

Instant Patch Resin

PRODUCTION DESCRIPTION

General Polymers 4700 INSTANT PATCH RESIN is a two component, multi-purpose urethane pot-hole, and concrete repair material. Material is mixed and cured at room temperature for patching holes, cracks, depressions and other surface imperfections on a variety of substrates. 4700 INSTANT PATCH RESIN sets within 2 minutes and the repaired area can be placed in service or recoated within 30 minutes at normal room temperatures. In cold temperatures larger batches can be mixed and applied as a floor finish.

ADVANTAGES

- Extremely fast cure
- Easy to mix, 1:1 pourable components or 22 ounce double barrel cartridges
- Non-shrinking
- Excellent wetting out characteristics
- Very low viscosity
- Traffic bearing hardness
- Cold temperature application and cure

TYPICAL USES

4700 INSTANT PATCH RESIN is designed for the repair and patching of floor surfaces when combined with a dry aggregate. The rapid cure and non-shrink properties of 4700 INSTANT PATCH RESIN allows for immediate return to service or serves as a solid repair material when recoating the floor.

LIMITATIONS

- **NOT** for use in expansion joints.
- Only mix quantities to be used within 2 minutes.
- Substrate must be structurally sound, and free of bond inhibiting contaminants.
- Substrate and aggregate must be dry.

TYPICAL PHYSICAL PROPERTIES @ 73F

Mix Ratio A: B (by volume)	1:1
Color	Cures to Opaque Gray
VOC (Volatile Organic Content)	
EPA Method 24	Compliant
SCAQMD Method 304	Compliant
Coverage	Varies with aggregate
Pot Life @ 73F	2-3 minutes
Initial Cure	15 minutes
Open to Traffic/Recoat	30 minutes
Abrasion Resistance	30-40 mgs lost
ASTM D 4060 CS-17 Wheel, 1,000 cycles	
Resistance to Elevated Temperatures	No slip or flow at required temperature of 158F
MIL-D-3134J	
Adhesion	300 psi
ACI 503R	(100% concrete failure)
Hardness, Shore D	75/80
ASTM D 2240	
Tensile Strength	2,800 psi
ASTM D 638	
Application Temperature Range	0°F to 90°F

SURFACE PREPARATION

Proper inspection and preparation of the substrate to receive resinous material is critical. Read and follow the "Instructions for Concrete Surface Preparation" (Form G-1) for complete details.

Clean and dry all surfaces prior to application of 4700 INSTANT PATCH RESIN. Remove loose and unsound substrate.

STORAGE / APPLICATION

• MATERIAL DELIVERY AND STORAGE

Store materials in accordance instructions, with seals and labels intact and legible. Keep resins, hardeners, and solvents separated from each other and away from sources of ignition. One year shelf life is expected for products stored between 50°F - 90°F.

• APPLICATION INSTRUCTIONS

Caution: Keep away from children! Keep away from flame or heat! 4700 INSTANT PATCH RESIN contains isocyanates which are harmful if inhaled or swallowed. It will irritate the skin and cause sensitization and/or dermatitis. It is toxic. **Consult MSDS before using. Use in a well ventilated area. Use an approved respirator if TLV is exceeded.**

4700 INSTANT PATCH RESIN contains polyols which under normal conditions do not represent a hazard but can be harmful if swallowed. Prolonged or repeated skin contact may cause skin irritation. Prolonged or repeated skin contact may cause burns, sensitization and/or dermatitis.

Ratio: Mix 1 part 4700A and 1 part 4700B thoroughly for 30 seconds (make certain that material at the sides of container is stirred into the center). Working life of material is 2-3 minutes depending on ambient temperature and mixed mass size.

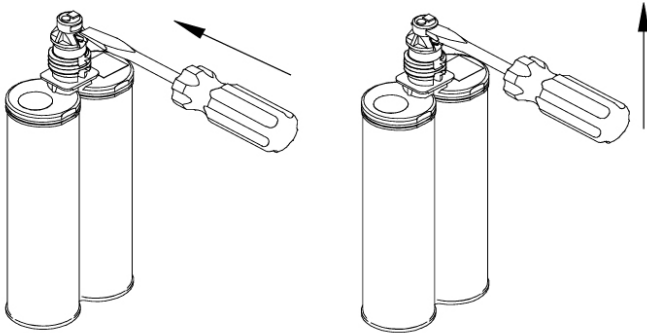

Agitate cartridge to thoroughly mix and any settled pigment components (at least 60 seconds). Remove the end cap. Attached static mixer and the retaining ring.

Cartridge Instructions:

1. To Remove Cap, Insert Flat Head of Screwdriver into Slot and Pry Upward
2. Cap can be re-inserted to seal a partially used cartridge. To avoid cross contamination, match up the circles and squares on the cap and top of cartridge body.
3. For 50mL Cartridges, the cap can be easily snapped off with your thumb and forefinger in the same upward motion.

Shallow Patches: Fill shallow areas (not deeper than ½ inch) to be patched with medium mesh dry sand (30 mesh or larger). Larger mesh sand may be used to facilitate resin penetration. Pour mixed 4700 into the sand allowing material to penetrate into the dry sand. Level the surface with a disposable straight edge.

Deep Patches: For patches greater than ½ inch in depth, combine 2 parts sand with 1 part mixed 4700 by volume. Mix until the sand is completely wetted. (Larger mesh sand requires slightly less resin for complete wetting.) Immediately place the mortar into the deep patch and smooth with a disposable straight edge.

Cold Temperature Applications: Reduced temperature will slow the set time and cure time. Larger batches can be mixed for patching and floor finishes. Mix one quart of 4700A with one quart of 4700B. Using a drill mixer and paddle blend with 25 pounds of 5115 Mortar Aggregate Blend until completely wetted out. Apply immediately to a properly prepared surface and finish within five minutes.

CHEMICAL RESISTANCE

For comprehensive chemical resistance information, consult the Chemical Resistant Guide and contact the Technical Service Department.

Cleanup

Clean up mixing and application equipment immediately after use. Use toluene or xylene. Observe all fire and health precautions when handling or storing solvents.

Safety

Refer to the MSDS sheet before use. All applicable federal, state, local and particular plant safety guidelines must be followed during the handling and installation and cure of these materials. Safe and proper disposal of excess materials shall be done in accordance with applicable federal, state, and local codes.

Maintenance

Occasional inspection of the installed material and spot repair can prolong system life. For specific information, contact the Technical Service Department.

Shipping

- Destinations East of the Rocky Mountains are shipped F.O.B. Cincinnati, Ohio.
- Destinations West of the Rocky Mountains are shipped F.O.B. Victorville, California.

For specific information relating to international shipments, contact your local sales representative.

Disclaimer

The information and recommendations set forth in this document are based upon tests conducted by or on behalf of The Sherwin-Williams Company. Such information and recommendations set forth herein are subject to change and pertain to the product(s) offered at the time of publication. Published technical data and instructions are subject to change without notice. Consult www.generalpolymers.com to obtain the most recent Product Data information and Application instructions.

Warranty

The Sherwin-Williams Company warrants our products to be free of manufacturing defects in accord with applicable Sherwin-Williams quality control procedures. Liability for products proven defective, if any, is limited to replacement of the defective product or the refund of the purchase price paid for the defective product as determined by Sherwin-Williams, NO OTHER WARRANTY OR GUARANTEE OF ANY KIND IS MADE BY SHERWIN-WILLIAMS, EXPRESSED OR IMPLIED, STATUTORY, BY OPERATION OF LAW OR OTHERWISE, INCLUDING MERCHANTABILITY AND FITNESS FOR A PARTICULAR PURPOSE.

